



Inverness Community Leadership Centre

Placemaking to grow community prosperity

PHASE II

Owned and operated by
Mill Road Social Enterprises

Inverness Community Leadership Centre

Placemaking to grow community prosperity

PHASE II



One stop-shop for community prosperity & health

Our Timeline

for growing community prosperity



MRSE Inverness Community Leadership Centre (ICLC) , Phase I completed

Name change from Inverness Cottage Workshop to Mill Road Social Enterprises - MRSE

\$2.5 million purchase and renovation of the old Mine pay offices on Mill Road in Inverness and the Inverness Community Leadership Centre (ICLC) is born.

MRSE expands services offered to persons living with disabilities

MRSE strategically grows its social enterprise operations and revenue streams to build a sustainable business model for the ICLC.

Inverness Cottage Workshop established

Formed in the basement of the old St Mary's hospital.

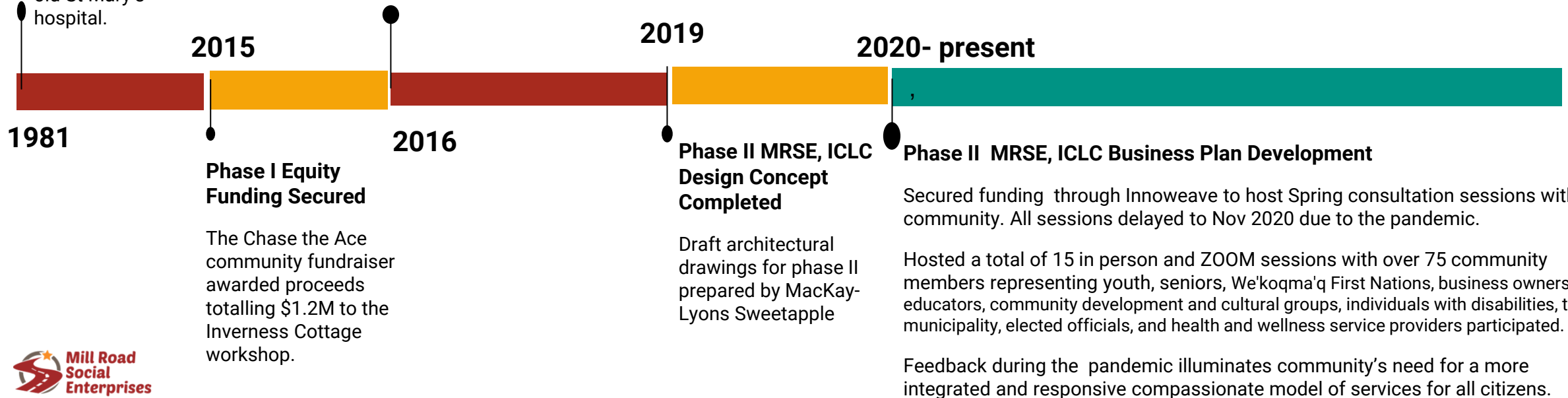

Groups & Community Leaders We Consulted



- Caregivers Nova Scotia
- Inverness Development Association
- Youth
- Municipality of Inverness
- Cape Breton Partnership
- Medical Professionals
- Seniors of Inverness
- We'koqma'q First Nations
- Inverness Heritage Gathering Park
- Business Owners
- Mental Health Peer Support Groups
- Inverness County Centre for the Arts
- Mill Road Social Enterprises staff & participants



The Project

Phase I - 7,500 sq/ft (completed 2016)

Phase II - 15,000 sq/ft

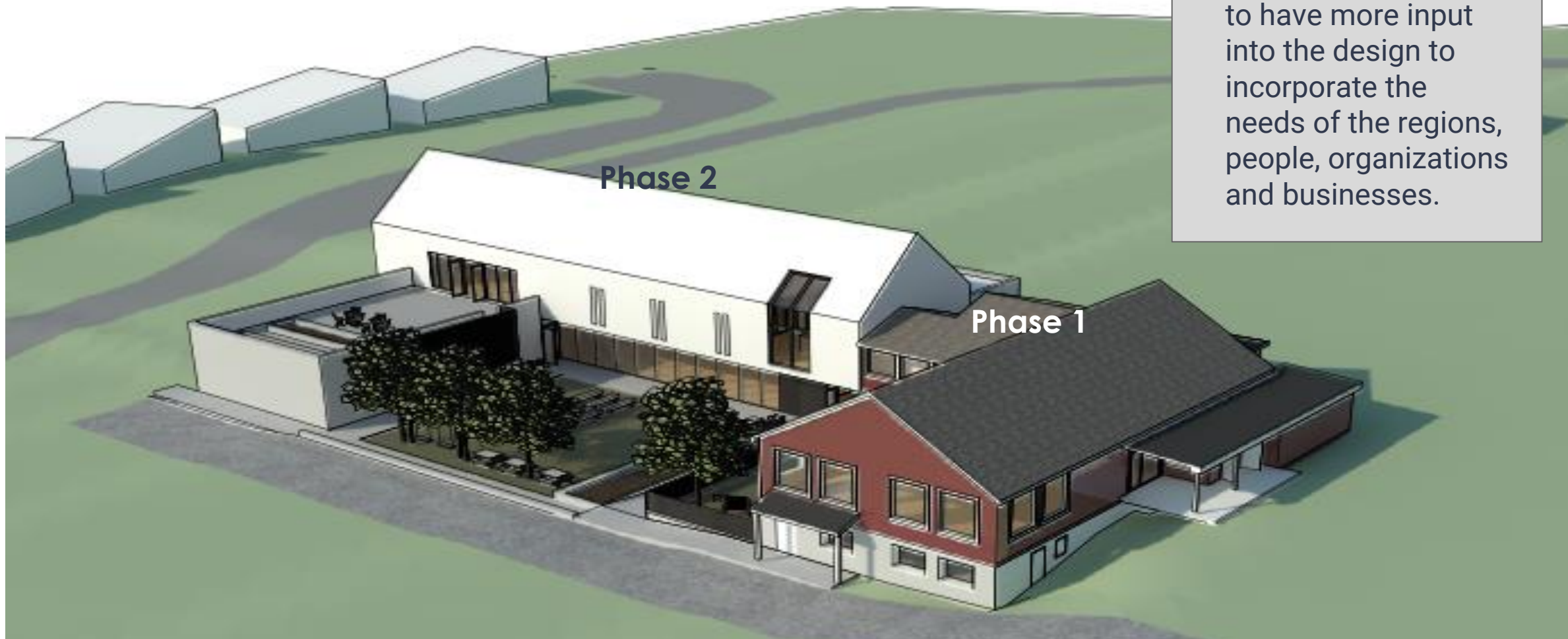

A key take away from our November community consultations was that Phase 2 needed to have more input into the design to incorporate the needs of the regions, people, organizations and businesses.

OUR OFFER One-stop Shop for Community Prosperity and Health



Childhood experiences



Housing



Education



Social support



Family income



Employment



Our communities



Access to health services

Prosperity; Focus on collaborations and partnerships

- Support for social enterprises
- Spaces for professional development
- Access to shared work spaces
- New service integration opportunities
- Increased social networking possibilities
- Access to training and education spaces and platforms
- Accessible technology hub for all citizens

Health; Focus on "Upstream" approach

- Inclusive safe spaces to support resilience
- Key Infant and early child development services
- Mental health support through peer to peer connections
- Nutrition and food security programs
- Intergenerational programming
- Technology to support remote service delivery
- Compassionate leadership addresses factors affecting poverty - *Education, training, isolation, addictions*

Social Determinants of Health

The conditions in which we are born, we grow and age

The conditions in which we live and work.

The foundation for economic development

Inverness Community Leadership Centre

PHASE II

Tenants and Community

Ongoing feedback will be collected from tenants, community groups and individual citizens to help shape the centre's operational priorities and programs.

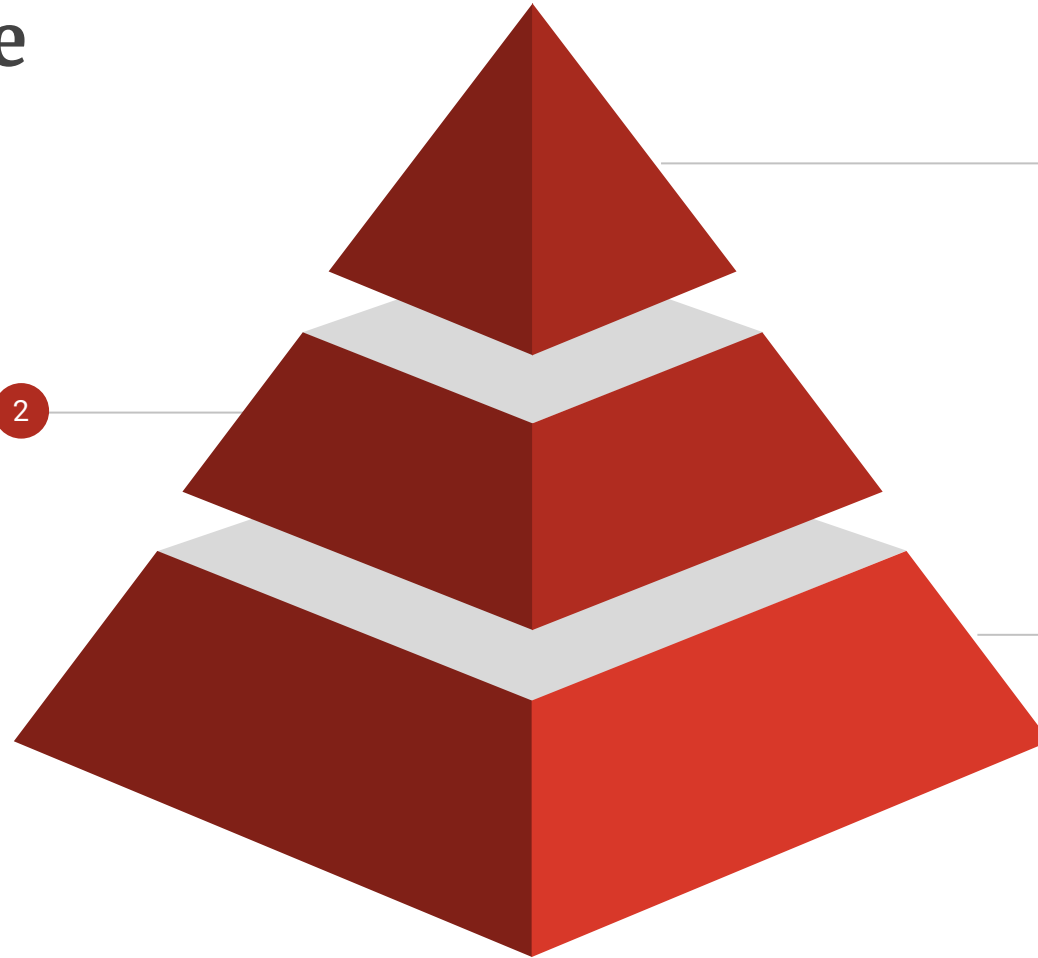

Mill Road Social Enterprises

As an established social enterprise with an 8 member board, Mill Road Social Enterprises will own and operate the ICLC.

ICLC Community Advisory Group

Phase II will be guided by a volunteer, advisory group of citizens with business, health and wellness, education, employment and business skills that will support the diverse and intergenerational interests of community members.

Key Service Areas To Grow Community Prosperity & Health

01

Business Innovation, Social
Enterprise & Economic Development

- Business Innovation and networking HUB
- Early childhood services/ cooperative
- Expanded space to grow existing and new social enterprises

02

Education and Literacy

- Satellite campus for NSCC/CBU
- Financial literacy hub
- Workshop space

03

Health and Wellness

- Safe welcoming space for all ages
- Community kitchen and cooking classes
- Space for youth and programming
- Meeting spaces for support groups
- Information and volunteer hub for all citizens
- Informal gathering space for all

Proposed Funding Partners

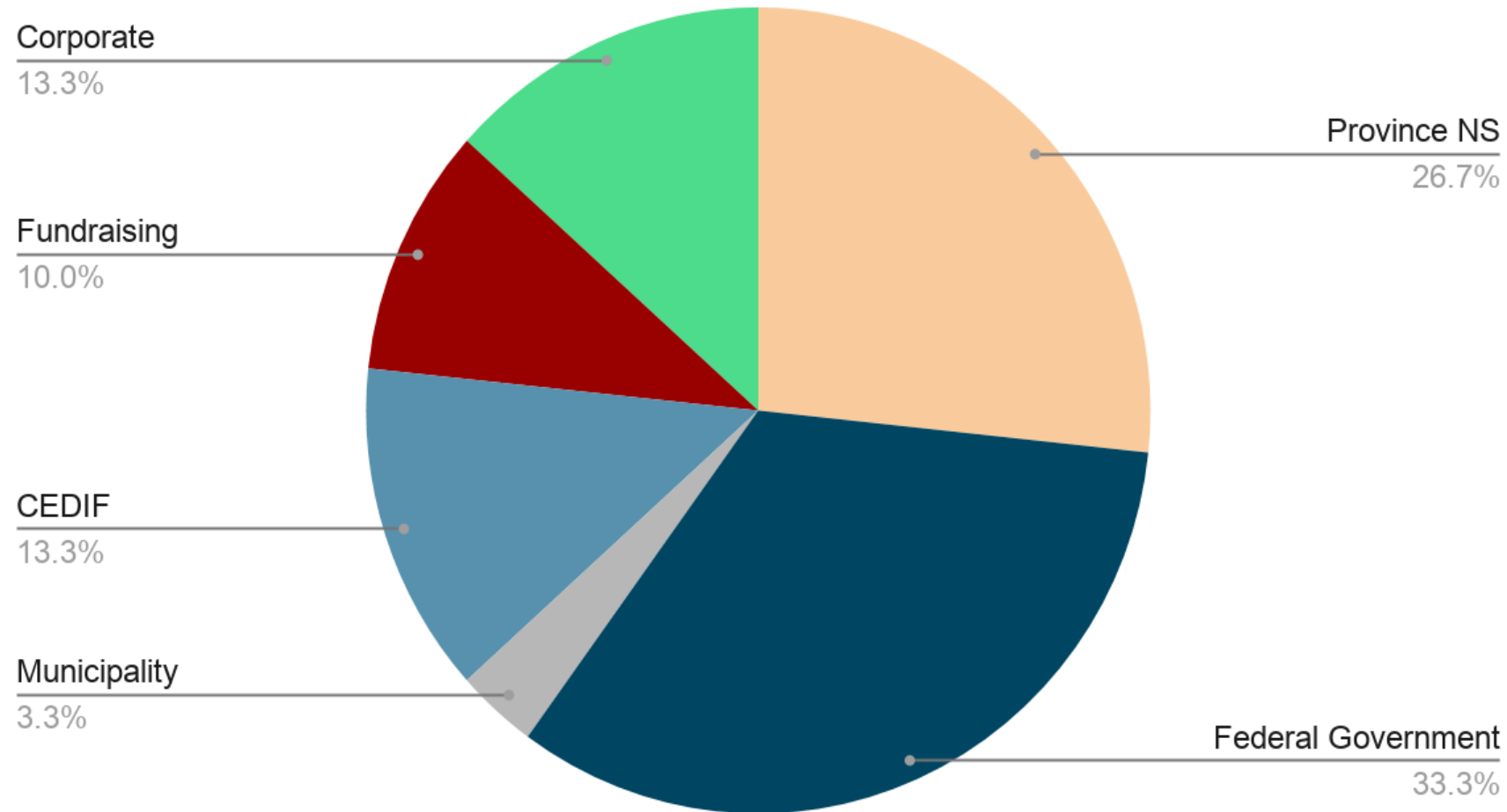

Estimated Phase II Cost
\$5M - 7M

What we believe...



A great public space cannot be measured by its physical attributes alone; *it must also serve people* as a vital community resource in which function always trumps form.

When people of **all ages, abilities, and socio-economic backgrounds** can not only access and enjoy a place, but also *play a key role in its identity, creation, and maintenance*, **that** is when we see genuine placemaking in action.

www.pps.org



Our thanks for your feedback on how to
gather support for *phase II* of the

Inverness Community Leadership Centre, *a place for growing community prosperity and health.*

Jim Mustard, Project Lead & Community Champion
jim_mustard@hotmail.com

Cindy O'Neill, Executive Director MRSE
cindy.millroadse@yahoo.com,

